

QJ10/600MPA

Vierpunktlager (metrisch)



Details:

Hauptabmessungen

d [mm]	600	D_1 [mm]	$\approx 773,7$
D [mm]	870	$r_{1,2}$ [mm]	6
B [mm]	118	α_0 [°]	35
Gewicht [kg]	≈ 255	a [mm]	≈ 515
d_1 [mm]	$\approx 696,3$		

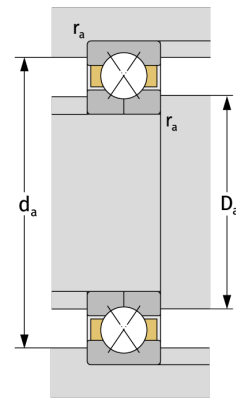
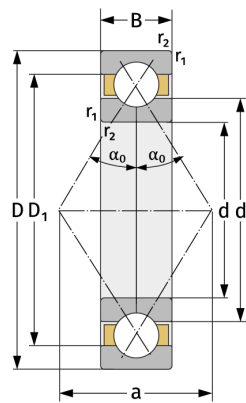

Anschlussmaße		Berechnungsdaten	
$d_{a, \min}$ [mm]	623	C [kN]	1410
$D_{a, \max}$ [mm]	847	C_0 [kN]	4250
$r_{a, \max}$ [mm]	5	C_u [kN]	79,1
		n_{th} [min ⁻¹]	450
		n_g [min ⁻¹]	960