

QJ10/670MPA

Vierpunktlager (metrisch)



Details:

Hauptabmessungen

d [mm]	670	D_1 [mm]	$\approx 868,3$
D [mm]	980	$r_{1,2}$ [mm]	7,5
B [mm]	136	α_0 [°]	35
Gewicht [kg]	≈ 379	a [mm]	≈ 578
d_1 [mm]	$\approx 781,7$		

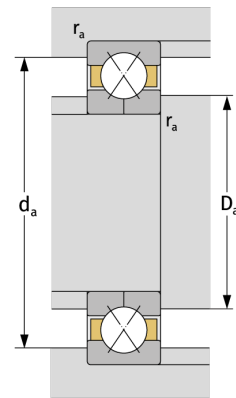
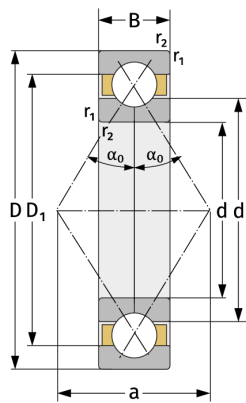

Anschlussmaße		Berechnungsdaten	
$d_{a, \min}$ [mm]	698	C [kN]	1650
$D_{a, \max}$ [mm]	952	C_0 [kN]	5350
$r_{a, \max}$ [mm]	6	C_u [kN]	93,9
		n_{th} [min ⁻¹]	389
		n_g [min ⁻¹]	830