

QJ1022MPA

Vierpunktlager (metrisch)



Details:

Hauptabmessungen

d [mm]	110	D_1 [mm]	$\approx 149,3$
D [mm]	170	$r_{1,2}$ [mm]	2
B [mm]	28	α_0 [°]	35
Gewicht [kg]	$\approx 2,55$	a [mm]	≈ 98
d_1 [mm]	$\approx 130,7$		

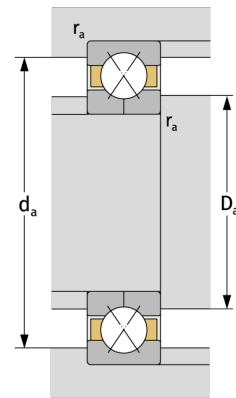
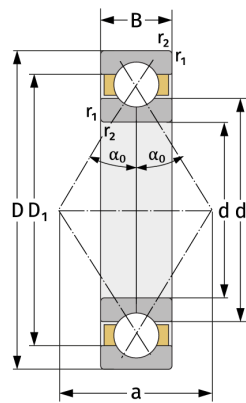

Anschlussmaße		Berechnungsdaten	
$d_{a, \min}$ [mm]	118,8	C [kN]	155
$D_{a, \max}$ [mm]	161,2	C_0 [kN]	191
$r_{a, \max}$ [mm]	2	C_u [kN]	7,87
		n_{th} [min ⁻¹]	3318
		n_g [min ⁻¹]	6200