

QJ19/670MPA

Vierpunktlager (metrisch)



Details:

Hauptabmessungen

d [mm]	670	D_1 [mm]	$\approx 820,6$
D [mm]	900	$r_{1,2}$ [mm]	6
B [mm]	103	α_0 [°]	35
Gewicht [kg]	≈ 203	a [mm]	≈ 550
d_1 [mm]	$\approx 749,4$		

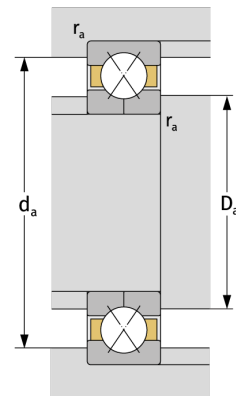
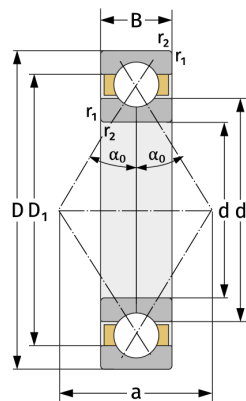

Anschlussmaße		Berechnungsdaten	
$d_{a, \min}$ [mm]	693	C [kN]	1330
$D_{a, \max}$ [mm]	877	C_0 [kN]	4120
$r_{a, \max}$ [mm]	5	C_u [kN]	74,1
		n_{th} [min ⁻¹]	404
		n_g [min ⁻¹]	880