

# QJ1916MPA

Vierpunktlager (metrisch)



## Details:

### Hauptabmessungen

d [mm]	80	$D_1$ [mm]	$\approx 99,6$
D [mm]	110	$r_{1,2}$ [mm]	1
B [mm]	16	$\alpha_0$ [°]	35
Gewicht [kg]	$\approx 0,48$	a [mm]	$\approx 67$
$d_1$ [mm]	$\approx 90,4$		

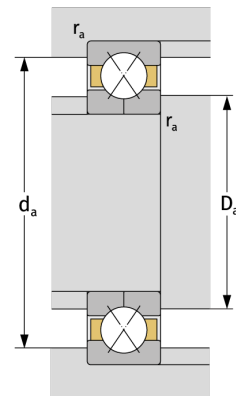
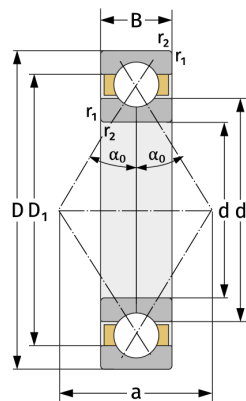

Anschlussmaße		Berechnungsdaten	
$d_{a, \min}$ [mm]	84,6	C [kN]	50,2
$D_{a, \max}$ [mm]	105,4	$C_0$ [kN]	65,6
$r_{a, \max}$ [mm]	1	$C_u$ [kN]	2,7
		$n_{th}$ [min <sup>-1</sup> ]	4185
		$n_g$ [min <sup>-1</sup> ]	9300