

QJ1921MPA

Vierpunktlager (metrisch)



Details:

Hauptabmessungen

d [mm]	105	D_1 [mm]	$\approx 131,2$
D [mm]	145	$r_{1,2}$ [mm]	1,1
B [mm]	20	α_0 [°]	35
Gewicht [kg]	$\approx 1,07$	a [mm]	≈ 88
d_1 [mm]	$\approx 118,8$		

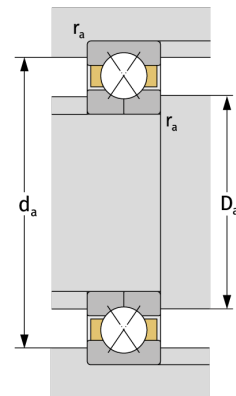
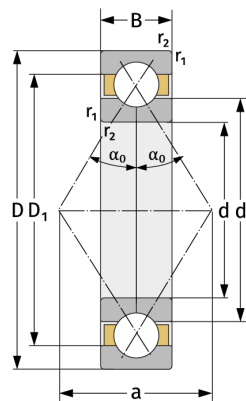

Anschlussmaße		Berechnungsdaten	
$d_{a, \min}$ [mm]	111	C [kN]	84,7
$D_{a, \max}$ [mm]	139	C_0 [kN]	117
$r_{a, \max}$ [mm]	1	C_u [kN]	5,09
		n_{th} [min ⁻¹]	3311
		n_g [min ⁻¹]	7000