

QJ1972MPA

Vierpunktlager (metrisch)



Details:

Hauptabmessungen

d [mm]	360	D_1 [mm]	$\approx 438,6$
D [mm]	480	$r_{1,2}$ [mm]	3
B [mm]	56	α_0 [°]	35
Gewicht [kg]	$\approx 30,6$	a [mm]	≈ 294
d_1 [mm]	$\approx 401,4$		

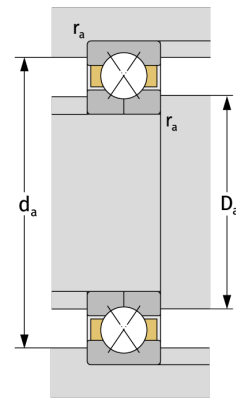
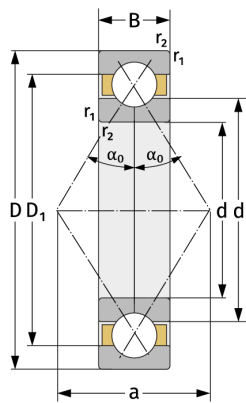

Anschlussmaße		Berechnungsdaten	
$d_{a, \min}$ [mm]	372,4	C [kN]	540
$D_{a, \max}$ [mm]	467,6	C_0 [kN]	1160
$r_{a, \max}$ [mm]	2,5	C_u [kN]	28,1
		n_{th} [min ⁻¹]	948
		n_g [min ⁻¹]	1900