

QJ1996MPA

Vierpunktlager (metrisch)



Details:

Hauptabmessungen

d [mm]	480	D_1 [mm]	$\approx 591,3$
D [mm]	650	$r_{1,2}$ [mm]	5
B [mm]	78	α_0 [°]	35
Gewicht [kg]	$\approx 81,3$	a [mm]	≈ 396
d_1 [mm]	$\approx 538,7$		

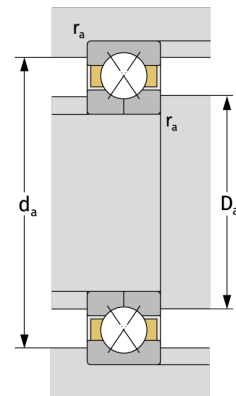
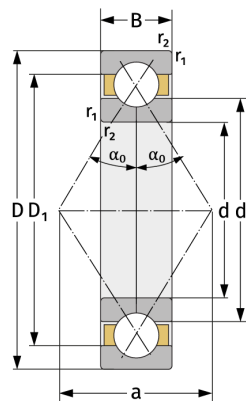

Anschlussmaße		Berechnungsdaten	
$d_{a, \min}$ [mm]	498	C [kN]	855
$D_{a, \max}$ [mm]	632	C_0 [kN]	2180
$r_{a, \max}$ [mm]	4	C_u [kN]	45,9
		n_{th} [min ⁻¹]	642
		n_g [min ⁻¹]	1400