

QJ216MPA

Vierpunktlager (metrisch)



Details:

Hauptabmessungen

d [mm]	80	D_1 [mm]	$\approx 119,3$
D [mm]	140	$r_{1,2}$ [mm]	2
B [mm]	26	α_0 [°]	35
Gewicht [kg]	$\approx 1,89$	a [mm]	≈ 77
d_1 [mm]	$\approx 100,7$		

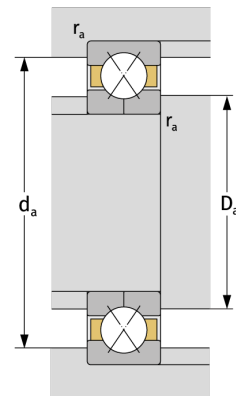
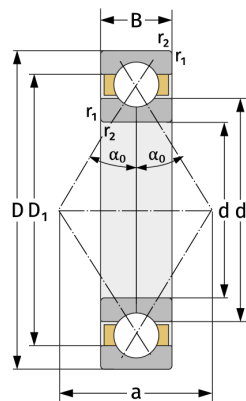

Anschlussmaße		Berechnungsdaten	
$d_{a, \min}$ [mm]	91	C [kN]	140
$D_{a, \max}$ [mm]	129	C_0 [kN]	146
$r_{a, \max}$ [mm]	2	C_u [kN]	6,76
		n_{th} [min ⁻¹]	4170
		n_g [min ⁻¹]	8000