

QJ224MPA

Vierpunktlager (metrisch)



Details:

Hauptabmessungen

d [mm]	120	D_1 [mm]	$\approx 182,2$
D [mm]	215	$r_{1,2}$ [mm]	2,1
B [mm]	40	α_0 [°]	35
Gewicht [kg]	$\approx 7,05$	a [mm]	≈ 117
d_1 [mm]	$\approx 152,8$		

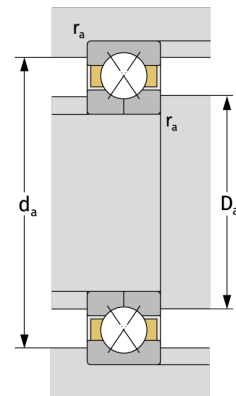
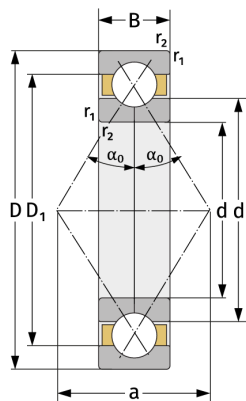

Anschlussmaße		Berechnungsdaten	
$d_{a, \min}$ [mm]	132	C [kN]	289
$D_{a, \max}$ [mm]	203	C_0 [kN]	340
$r_{a, \max}$ [mm]	2,1	C_u [kN]	12,9
		n_{th} [min ⁻¹]	3071
		n_g [min ⁻¹]	5200