

QJ232MPA

Vierpunktlager (metrisch)



Details:

Hauptabmessungen

d [mm]	160	D_1 [mm]	$\approx 243,6$
D [mm]	290	$r_{1,2}$ [mm]	3
B [mm]	48	α_0 [°]	35
Gewicht [kg]	$\approx 15,9$	a [mm]	≈ 158
d_1 [mm]	$\approx 206,4$		

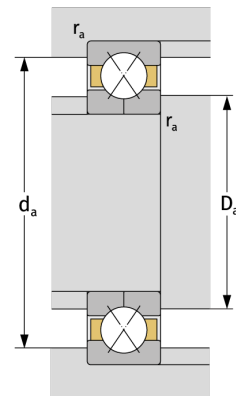
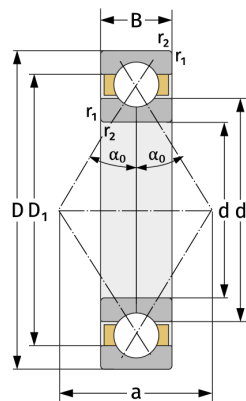

Anschlussmaße		Berechnungsdaten	
$d_{a, \min}$ [mm]	174	C [kN]	414
$D_{a, \max}$ [mm]	276	C_0 [kN]	590
$r_{a, \max}$ [mm]	2,5	C_u [kN]	19,3
		n_{th} [min ⁻¹]	2119
		n_g [min ⁻¹]	3800