

QJ336MPA

Vierpunktlager (metrisch)



Details:

Hauptabmessungen

d [mm]	180	D_1 [mm]	$\approx 307,8$
D [mm]	380	$r_{1,2}$ [mm]	4
B [mm]	75	α_0 [°]	35
Gewicht [kg]	$\approx 47,1$	a [mm]	≈ 196
d_1 [mm]	$\approx 252,2$		

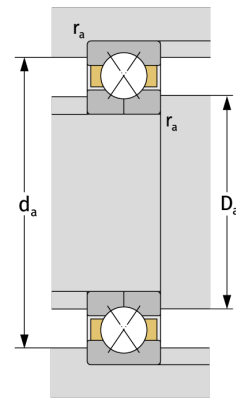
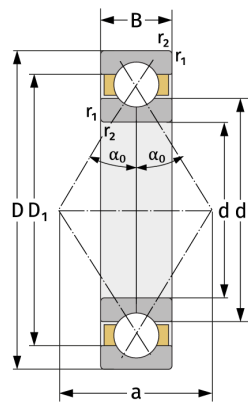

Anschlussmaße		Berechnungsdaten	
$d_{a, \min}$ [mm]	197	C [kN]	655
$D_{a, \max}$ [mm]	363	C_0 [kN]	1030
$r_{a, \max}$ [mm]	3	C_u [kN]	30,3
		n_{th} [min ⁻¹]	1480
		n_g [min ⁻¹]	3000