

QJ348MPA

Vierpunktlager (metrisch)



Details:

Hauptabmessungen

d [mm]	240	D_1 [mm]	$\approx 407,1$
D [mm]	500	$r_{1,2}$ [mm]	5
B [mm]	95	α_0 [°]	35
Gewicht [kg]	≈ 103	a [mm]	≈ 259
d_1 [mm]	$\approx 332,9$		

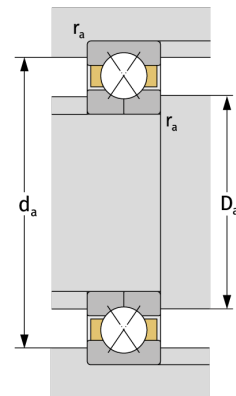
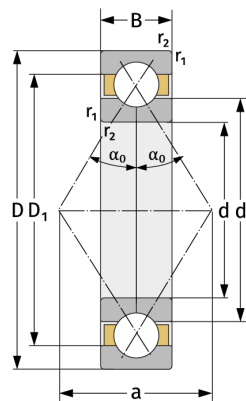

Anschlussmaße		Berechnungsdaten	
$d_{a, \min}$ [mm]	260	C [kN]	980
$D_{a, \max}$ [mm]	480	C_0 [kN]	1820
$r_{a, \max}$ [mm]	4	C_u [kN]	47,1
		n_{th} [min ⁻¹]	998
		n_g [min ⁻¹]	2200